

**NEWS RELEASE****November 19th, 2013**

Trading Symbols:

AMM :TSX, AAU : NYSE MKT

www.almadenminerals.com

**ALMADEN INFILL DRILLING ON MAIN ZONE,  
HITS 30.90 METERS OF 3.38 G/T AU, 230.8 G/T AG (8.0 G/T AUEQ) AT IXTACA, MEXICO**

**Almaden Minerals Ltd. (“Almaden” or “the Company”;** AMM: TSX; AAU: NYSE MKT) is pleased to announce the results from Almaden’s ongoing 2013 Ixtaca Zone drill program at the Company’s 100% owned Tuligtic project, Mexico. The infill program has been designed to upgrade resources currently in the inferred category to the higher confidence measured and indicated categories. The holes announced today show the continuity and high grades of the Main and Northern zones defined with previous drilling. Highlights from the holes released today include the following intercepts (a more complete list of intercepts is shown in the table below):

**Hole TU-13-333                      NORTH ZONE SECTION 10725 EAST, 330 Az, -40 dip**  
10.00 meters @ 0.84 g/t gold and 128.0 g/t silver (3.4 g/t gold equivalent)  
    Including                      2.00 meters @ 3.71 g/t gold and 571.0 g/t silver (15.1 g/t gold equivalent)  
54.00 meters @ 0.62 g/t gold and 54.5 g/t silver (1.7 g/t gold equivalent)

**Hole TU-13-339                      MAIN ZONE SECTION 10775 EAST, 145 Az, -42 dip**  
144.00 meters @ 0.52 g/t gold and 40.5 g/t silver (1.3 g/t gold equivalent)  
    Including                      9.50 meters @ 2.08 g/t gold and 78.0 g/t silver (3.6 g/t gold equivalent)  
    And                              8.10 meters @ 1.04 g/t gold and 183.0 g/t silver (4.7 g/t gold equivalent)

**Hole TU-13-343                      MAIN ZONE SECTION 10775 EAST, 145 Az, -30 dip**  
81.00 meters @ 1.49 g/t gold and 106.6 g/t silver (3.6 g/t gold equivalent)  
    Including                      30.90 meters @ 3.38 g/t gold and 230.8 g/t silver (8.0 g/t gold equivalent)  
    And                              6.00 meters @ 9.95 g/t gold and 896.2 g/t silver (27.9 g/t gold equivalent)

J.D. Poliquin, chairman of Almaden stated, “Today’s holes show the continuity of this part of the Main and Northern Zones and highlights the high grades that core these zones. The infill drilling program underway was designed to upgrade the confidence of our resource base. It also provides an opportunity to remind our shareholders that the Ixtaca zone of veining is cored by several well defined and intensely mineralised high grade gold silver zones that have good continuity along strike.”

Below is a plan map and relevant sections which will be posted to the Company’s website (www.almadenminerals.com).

**About the Ixtaca Property**

The 100% owned Ixtaca zone is a blind discovery made by the Company in 2010. The Main Ixtaca and Ixtaca North Zones of veining are interpreted to have a north-easterly trend. Holes to date suggest that the Main Ixtaca and Ixtaca North Zones are sub vertical with local variations. This interpretation suggests that true widths range from approximately 35% of intersected widths for a -70 degree hole to 94% of intersected widths for a -20 degree hole. The drilling completed to date has traced mineralisation over 1,000 meters along this northeast trend. The Chemalaco (Northeast Extension) Zone strikes roughly north-south (340 azimuth) and dips at 55 degrees to the west. This interpretation suggests that true widths range from approximately 82% of intersected widths for a -70 degree hole to 99% of intersected widths for a -40 degree hole.

Hole #	From (m)	To (m)	Interval (m)	Au (g/t)	Ag (g/t)	AuEq (g/t)	AgEq (g/t)	SECTION
TU-13-330	36.58	47.50	10.92	0.62	31.8	1.3	63	10725E
including	37.80	42.80	5.00	1.11	37.9	1.9	94	
TU-13-330	62.00	96.25	34.25	0.16	11.2	0.4	19	
including	65.50	67.00	1.50	0.51	34.0	1.2	60	
TU-13-330	155.00	159.65	4.65	0.73	53.2	1.8	90	
TU-13-330	172.60	192.00	19.40	0.16	11.9	0.4	20	
TU-13-333	43.60	58.30	14.70	0.14	4.5	0.2	11	10725E
TU-13-333	87.00	89.50	2.50	0.37	27.1	0.9	45	
TU-13-333	125.00	135.00	10.00	0.84	128.0	3.4	170	
including	125.00	127.00	2.00	3.71	571.0	15.1	757	
TU-13-333	152.00	206.00	54.00	0.62	54.5	1.7	86	
including	152.00	153.00	1.00	7.33	545.5	18.2	912	
including	172.75	175.50	2.75	1.41	95.6	3.3	166	
including	194.00	202.00	8.00	0.93	106.5	3.1	153	
TU-13-337	97.00	126.00	29.00	0.62	44.3	1.5	75	10775E
including	100.00	103.50	3.50	1.46	141.4	4.3	214	
including	115.00	120.00	5.00	1.27	74.4	2.8	138	
TU-13-337	150.00	160.00	10.00	0.55	5.5	0.7	33	
TU-13-337	174.00	200.56	26.56	0.24	11.8	0.5	24	
TU-13-339	82.00	87.50	5.50	0.27	10.3	0.5	24	10775E
TU-13-339	99.00	243.00	144.00	0.52	40.5	1.3	67	
including	164.90	167.50	2.60	0.65	53.0	1.7	86	
including	170.00	173.50	3.50	0.79	45.7	1.7	85	
including	179.00	188.50	9.50	2.08	78.0	3.6	182	
including	204.20	206.70	2.50	1.43	90.9	3.3	163	
including	219.50	227.60	8.10	1.04	183.0	4.7	235	
including	222.00	225.50	3.50	1.73	374.4	9.2	461	
including	231.25	233.75	2.50	1.63	118.0	4.0	200	
TU-13-343	35.00	42.00	7.00	0.74	83.8	2.4	121	10775E
including	35.50	36.50	1.00	4.47	520.7	14.9	744	
TU-13-343	67.80	75.00	7.20	0.19	8.2	0.4	18	
TU-13-343	97.50	99.50	2.00	0.22	112.5	2.5	123	
TU-13-343	105.00	107.10	2.10	0.16	43.1	1.0	51	
TU-13-343	112.50	124.50	12.00	0.49	26.7	1.0	51	
including	118.00	119.25	1.25	0.59	142.0	3.4	171	
TU-13-343	139.00	220.00	81.00	1.49	106.6	3.6	181	
including	164.10	195.00	30.90	3.38	230.8	8.0	400	
including	164.10	168.40	4.30	3.55	143.6	6.4	321	
including	178.50	184.50	6.00	9.95	896.2	27.9	1394	
including	192.80	195.00	2.20	2.96	59.0	4.1	207	
TU-13-346	33.50	39.50	6.00	0.07	18.7	0.4	22	
TU-13-346	53.00	72.54	19.54	0.51	22.6	1.0	48	
TU-13-346	141.00	147.00	6.00	0.21	23.4	0.7	34	
TU-13-346	191.00	195.00	4.00	0.03	33.6	0.7	35	

Mr. Norm Dircks, P.Geol., a qualified person (“QP”) under the meaning of NI 43-101, is the QP and project manager of Almaden’s Ixtaca program and reviewed the technical information in this news release. The analyses reported were carried out at ALS Chemex Laboratories of North Vancouver using industry standard analytical techniques. For gold, samples are first analysed by fire assay and atomic absorption spectroscopy (“AAS”). Samples that return values greater than 10 g/t gold using this technique are then re-analysed by fire assay but with a gravimetric finish. Silver is first analysed by Inductively Coupled Plasma - Atomic Emission Spectroscopy (“ICP-AES”). Samples that return values greater than 100 g/t silver by ICP-AES are then re-analysed by HF-HNO<sub>3</sub>-HClO<sub>4</sub> digestion with HCL leach and ICP-AES finish. Of these samples those that return silver values greater than 1,500 g/t are further analysed by fire assay with a gravimetric finish.

Blanks, field duplicates and certified standards were inserted into the sample stream as part of Almaden's quality assurance and control program which complies with National Instrument 43-101 requirements. Gold equivalent ("AuEq" or "Gold Eq.") and silver equivalent ("AgEq" or "Silver Eq.") values were calculated using silver to gold ratios of 50 to 1. The ratio of 50 to 1 was used for the sake of consistency with past news releases. Intervals that returned assays below detection were assigned zero values. Metallurgical recoveries and net smelter returns are assumed to be 100% for these calculations.

### **About Almaden**

Almaden is a well-financed mineral exploration company working in North America. The company has assembled mineral exploration projects, including the Ixtaca Zone and the Tuligtic project, through its grass roots exploration efforts. While the properties are largely at early stages of development they represent exciting opportunities for the discovery of significant gold, silver and copper deposits as evidenced at Ixtaca. Almaden's business model is to find and acquire mineral properties and develop them by seeking option agreements with others who can acquire an interest in a project by making payments and exploration expenditures. Through this means the company has been able to expose its shareholders to discovery and capital gain without the funding and consequent share dilution that would be required if the company were to have developed these projects without a partner. The company intends to expand this business model, described by some as prospect generation, by more aggressively exploring several of its projects including the Ixtaca Zone.

On Behalf of the Board of Directors

"Morgan Poliquin"

Morgan J. Poliquin, Ph.D., P.Eng.  
President, CEO and Director  
Almaden Minerals Ltd.

*Neither the Toronto Stock Exchange (TSX) nor the NYSE MKT have reviewed or accepted responsibility for the adequacy or accuracy of the contents of this news release which has been prepared by management. Except for the statements of historical fact contained herein, certain information presented constitutes "forward-looking statements" within the meaning of the United States Private Securities Litigation Reform Act of 1995 and Canadian securities laws. Such forward-looking statements, including but not limited to, those with respect to potential expansion of mineralization, potential size of mineralized zone, and size and timing of exploration and development programs, estimated project capital and other project costs and the timing of submission and receipt and availability of regulatory approvals involve known and unknown risks, uncertainties and other factors which may cause the actual results, performance or achievement of Almaden to be materially different from any future results, performance or achievements expressed or implied by such forward-looking statements. Such factors include, among others, risks related to international operations and joint ventures, the actual results of current exploration activities, conclusions of economic evaluations, uncertainty in the estimation of mineral resources, changes in project parameters as plans continue to be refined, environmental risks and hazards, increased infrastructure and/or operating costs, labour and employment matters, and government regulation and permitting requirements as well as those factors discussed in the section entitled "Risk Factors" in Almaden's Annual Information form and Almaden's latest Form 20-F on file with the United States Securities and Exchange Commission in Washington, D.C. Although Almaden has attempted to identify important factors that could cause actual results to differ materially, there may be other factors that cause results not to be as anticipated, estimated or intended. There can be no assurance that such statements will prove to be accurate as actual results and future events could differ materially from those anticipated in such statements. Almaden disclaims any intention or obligation to update or revise any forward-looking statements, whether as a result of new information, future events or otherwise, other than as required pursuant to applicable securities laws. Accordingly, readers should not place undue reliance on forward-looking statements.*



**Blue highlighted sections contain holes announced in latest release. Please see sections for assay intervals.**

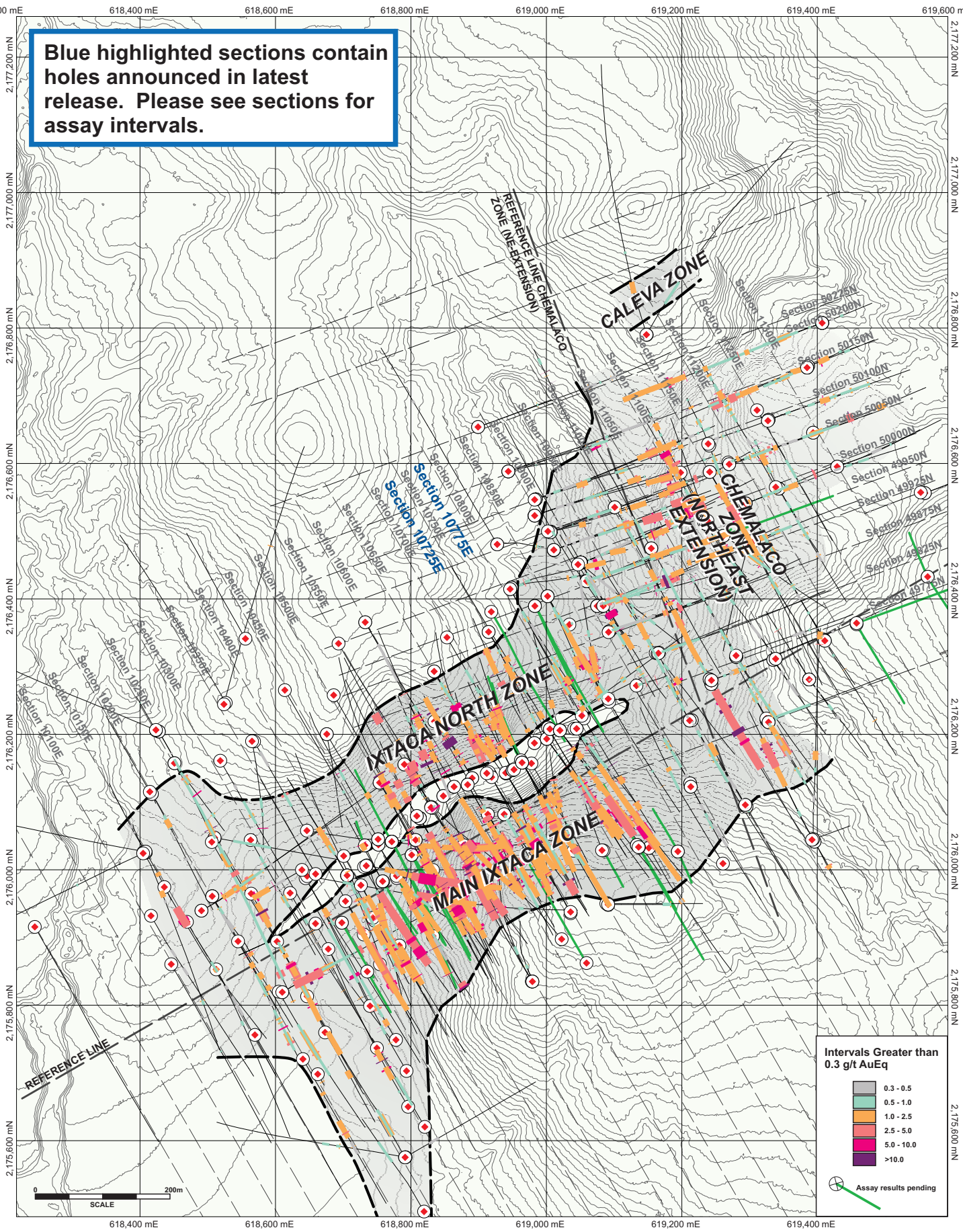

**Intervals Greater than 0.3 g/t AuEq**

Grey	0.3 - 0.5
Light Green	0.5 - 1.0
Orange	1.0 - 2.5
Yellow	2.5 - 5.0
Red	5.0 - 10.0
Purple	>10.0

Assay results pending



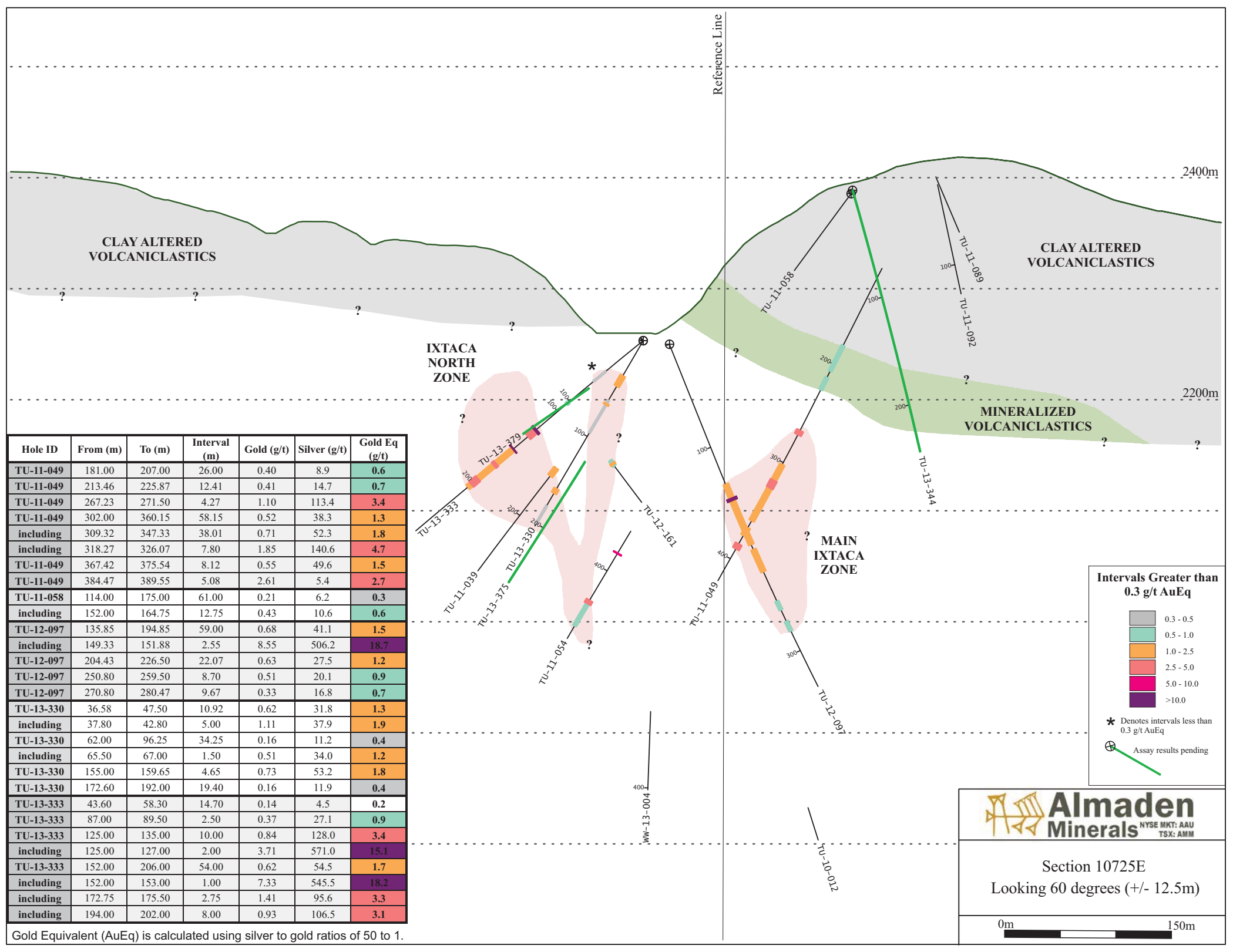

Hole ID	From (m)	To (m)	Interval (m)	Gold (g/t)	Silver (g/t)	Gold Eq (g/t)
TU-11-049	181.00	207.00	26.00	0.40	8.9	0.6
TU-11-049	213.46	225.87	12.41	0.41	14.7	0.7
TU-11-049	267.23	271.50	4.27	1.10	113.4	3.4
TU-11-049	302.00	360.15	58.15	0.52	38.3	1.3
including	309.32	347.33	38.01	0.71	52.3	1.8
including	318.27	326.07	7.80	1.85	140.6	4.7
TU-11-049	367.42	375.54	8.12	0.55	49.6	1.5
TU-11-049	384.47	389.55	5.08	2.61	5.4	2.7
TU-11-058	114.00	175.00	61.00	0.21	6.2	0.3
including	152.00	164.75	12.75	0.43	10.6	0.6
TU-12-097	135.85	194.85	59.00	0.68	41.1	1.5
including	149.33	151.88	2.55	8.55	506.2	18.7
TU-12-097	204.43	226.50	22.07	0.63	27.5	1.2
TU-12-097	250.80	259.50	8.70	0.51	20.1	0.9
TU-12-097	270.80	280.47	9.67	0.33	16.8	0.7
TU-13-330	36.58	47.50	10.92	0.62	31.8	1.3
including	37.80	42.80	5.00	1.11	37.9	1.9
TU-13-330	62.00	96.25	34.25	0.16	11.2	0.4
including	65.50	67.00	1.50	0.51	34.0	1.2
TU-13-330	155.00	159.65	4.65	0.73	53.2	1.8
TU-13-330	172.60	192.00	19.40	0.16	11.9	0.4
TU-13-333	43.60	58.30	14.70	0.14	4.5	0.2
TU-13-333	87.00	89.50	2.50	0.37	27.1	0.9
TU-13-333	125.00	135.00	10.00	0.84	128.0	3.4
including	125.00	127.00	2.00	3.71	571.0	15.1
TU-13-333	152.00	206.00	54.00	0.62	54.5	1.7
including	152.00	153.00	1.00	7.33	545.5	18.2
including	172.75	175.50	2.75	1.41	95.6	3.3
including	194.00	202.00	8.00	0.93	106.5	3.1

Gold Equivalent (AuEq) is calculated using silver to gold ratios of 50 to 1.

**Almaden Minerals**  
 NYSE MKT: AAU  
 TSX: AMM

Section 10725E  
 Looking 60 degrees (+/- 12.5m)

0m 150m

